

CMV Truck & Bus set the wheels in motion for a prime move...

In June 2016, a formal soil-turning ceremony by CMV Group Managing Director, Paul Crawford, marked the start of construction on the new CMV Truck & Bus Dealership Facility located in Derrimut, Victoria.

The new, state-of-the-art complex will consist of two-storey administration offices, a purpose-built training centre, showrooms, parts warehouse, staff facilities, service roads and drop off points, as well as two east and west buildings housing up to 100 workshop bays. The new facility slated for completion in August 2017, will reinforce CMV's commitment to its partners and customers alike. CMV's investment of AUD\$20m in the new site aims to enhance their service offer to customers, as well as their ongoing support of the Volvo Truck & Bus, Mack and UD brands.

Set the arduous task of withstanding the constant rigours of heavy vehicular loads anticipated at CMV Truck & Bus facility, the design and specification of the 20,000m² of internal and 50,000m² of external concrete pavements was placed in the hands of leading structural and civil engineering firm, Bruce Young Partners.

Critical to the design of the complex was the specification of load transfer and edge protection solutions that not only deliver a serviceable floor, but would protect and prolong the working life of CMV's newest asset.

With that in mind, Bruce Young Partners turned to the ramsetreid® range of Danley™ load transfer and edge protection systems. At the construction joints (or stop pours), Bruce Young Partners specified the 10mm Diamond™ Dowel, the innovative and patented diamond shaped load transfer plate dowel and sleeve system which complies with TR34 (4th Edition), providing load capacity at joint gaps widths up to 20mm. Likewise, for load transfer at the contraction joints (or sawcut joints), the Danley PD3™ Plate Dowel system was specified to also limit different deflection at ≤0.25mm, which complies with ACI360R-10.

To address the need to protect the slab edges at the roller doors (between the internal and external slabs) from heavy vehicular and the small hard wheels of material handling equipment, Bruce Young Partners selected the Danley Hyper ArmourMate™ edge protection full-joint system.

Not only does ArmourMate provide load transfer, deflection control and protects slab edges from spalling caused by heavy vehicular loads in high traffic areas, the Galvanised Hyper ArmourMate

Continued >

Location	Derrimut, VIC
Project Size	20,000m ² (Internal) 50,000m ² (External)
Client	CMV Truck & Bus
Engineers	Bruce Young Partners
Builder	Qanstruct Pty Ltd
Contractor	Anglo Italian Concrete
Distributor	Lee Supplies
Project value	\$20m
Finish Date	August, 2017
Products Used	Diamond™ Dowel PD3™ Plate Dowel Cradles Hyper Armourmate™ Danley™ Tall Combination Chairs





1

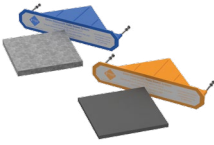

2



3



4



- (1) Diamond Dowel
- (2) PD3
- (3) Hyper ArmourMate
- (4) Tall Combination Chairs

(hot dipped galvanised in accordance to AS/NZS 4680) will also stand guard in all extremes of weather.

To bring the CMV vision to life, commercial and industrial construction company, Qanstruct Pty Ltd, enlisted the services of leading Melbourne based concrete contractors Anglo-Italian Concrete (AIC). Specialists in super flat floors and fibre reinforced concrete, AIC were the perfect fit to construct and pour the combined 70,000m² of internal and external pavements at the site. As a result of their long and strong working history with ramsetreid, the crew at AIC found the installation of the Danley Diamond Dowels, PD3 Plate Dowel Cradles and the Hyper ArmourMate systems were second nature.

The strong working relationship between AIC and ramsetreid was clearly evident during a site visit kindly hosted by John Molinia - Site Foreman AIC. In attendance were UK based, Andrew Mines (Group President – ITW Construction

Products), Richard McCarthy (ramsetreid VPGM), Andrew Coumaros (ramsetreid Segment Engineer) and Jim Kovos (ramsetreid Territory Manager). Richard McCarthy explains that “what really resonated with me was the collaborative interaction between ramsetreid and the Anglo Italian crew on site. This partnership clearly operates far beyond a base level supplier-customer relationship. The free flowing exchange of ideas and solutions to overcome the challenges of industrial slab-on-ground construction was a testament to the quality output we saw at CMV.”

With the finishing touches being applied to the internal and external slabs by AIC in June, CMV Truck & Bus are on track to make the move into their state-of-the-art facility in August, 2017.

To learn more about Danley products [click here](#).

